

TECHNICAL INFORMATION

COLUMN DESIGN	:	ILE TR7./ BS-CP3
MATERIAL	:	BS 4360 G50A / JIS G3101 SS400
BASIC WIND SPEED	:	35 m/s
TOPOGRAPHY FACTOR	:	1
TERRAIN CATERGORY	:	2
EXPOSURE PERIOD	:	25 YEARS
WELDING CONFORMS TO	:	BS 5135
GALVANIZING CONFORMS TO	:	BS 729

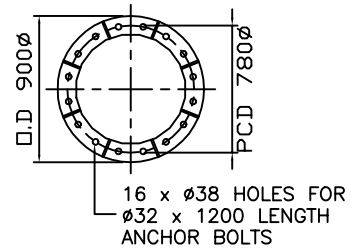

FLANGE PLATE
STIFFENED WITH GUSSET PLATE

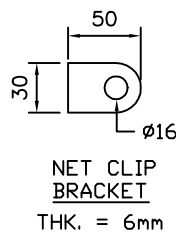
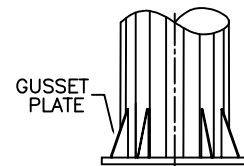
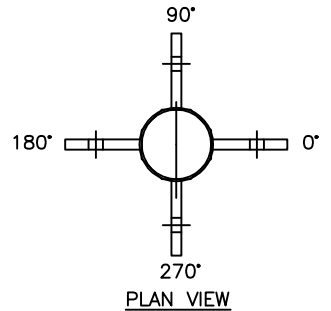
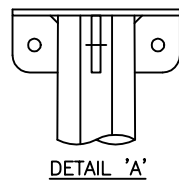
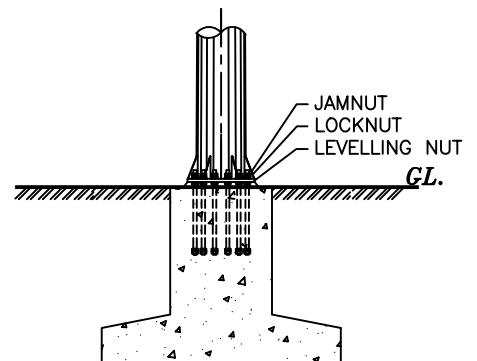

45 Briggs Street, Welshpool,
Western Australia 6106
P: 1300 790 343
E: sales@galvanisedpolesaustralia.com
www.galvanisedpolesaustralia.com

CLIENT : -

DRAW NO : 35M/NP/FM/01/R0

PROJECT : -

FILE NAME : NP ISO STD

DATE : 15-09-2010

DRAWN BY : D.C.

INCHARGE BY : D.C.

SCALE : N.T.S

DRAWING TITLE :

CHECK/APPR. BY : D.C.

A4 SIZE

35M NETTING POLE FM

THIS DRAWING IS THE PROPERTY OF GALVANISED POLES AUSTRALIA AND MUST NOT BE REPRODUCED WITHOUT THEIR PRIOR CONSENT IN WRITING.